

PASSango

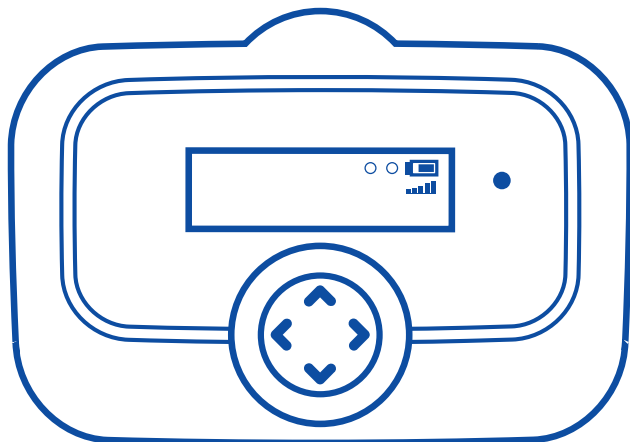

INSTALLATION REQUIREMENTS ON BOARD UNIT



as24.com/PASSango-guides

BG / CS / DE / EN / ES / FR / HU / IT / LT / NL / PL / PT / RO / RU / SL / TU



Connection

The OBU (On Board Unit) has to be connected to the fuse box as specified by the truck manufacturer.



Important

The cable for the fixed installation supplied with the OBU is composed of **3 wires**:

- **Brown:** mass
- **Red:** +12-24V permanent power supply
- **Black:** ignition +12-24V associated with the engine contact

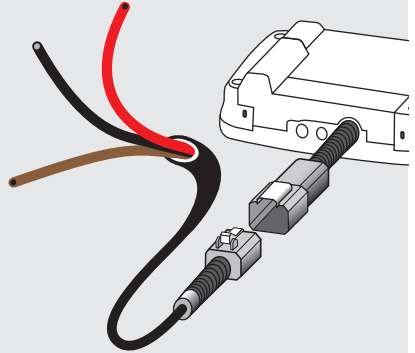

For the proper functioning of the OBU, **it must remain permanently connected.**

The positioning of the OBU on the windscreen must conform to the diagram.

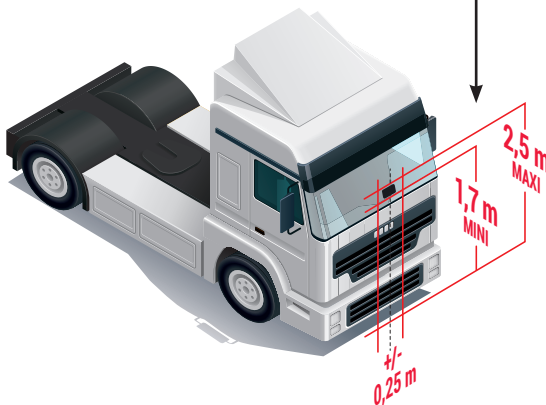

Installation Requirements



NO



▶ Positioning device on bottom middle



YES



▶ Plugging on fuse box

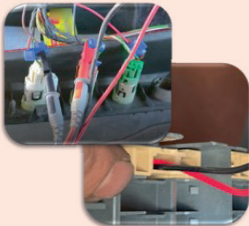
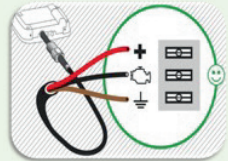

▶ Cabling in 1 dedicated plug

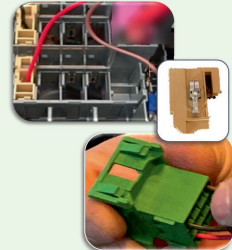

Caution: Make sure that no other telebadge can interfere with your OBU PASSango.

Installation Requirements



NO



YES



▶ Using the right cable & connector ▶



▶ Using the right equipment ▶



▶ Protecting cables ▶



Initialize

1 STARTING THE OBU

1. Once your OBU connected, the automatic initialization procedure starts (around 2 min).



2. The navigation button must be green and all subscribed services should be displayed.



2 CHECK UP

Check status on the screen



EXT. POWER : ON
BATTERY : OK
IGNITION : OFF
MOVEMENT : OFF

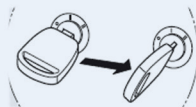

EXT. POWER : ON
BATTERY : OK
IGNITION : ON
MOVEMENT : OFF

EXT. POWER :

ON : Connected
OFF* : Not connected
ERROR : Error

IGNITION :

ON : Correct permanent power supply
OFF** : Temporary power supply
ERROR* : Connection error - check the installation

BATTERY :

OK : Running
LOW : Plug the OBU
ERROR : Internal battery unplugged

MOVEMENT :

| WHEN IGNITION IS ON | WHEN IGNITION IS OFF |
|---------------------|---------------------------|
| ON : Engine on | ON : Detected movement |
| OFF : Engine off | OFF : Undetected movement |

* Cf connection requirements.

** Your OBU is only connected with 2 wires or to the cigar lighter, please respect the connection to your vehicle's fuse box with the 3 wires.

Responsability



The use of the telebadge must comply with the general terms and conditions of sale and the regulations in the Toll Domain crossed. You are responsible for the correct operation of the OBU into the accepting tolling networks. In this respect, you must ensure that **the information entered is up to date, that the telebadge is duly installed and that it is in good working order**, at all times of vehicle driving.

